

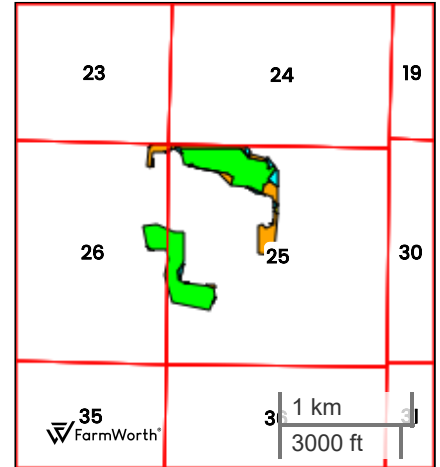

LEGACY TIMBER GROUP LLC (350.99 AC TOTAL, 85.52 AC TILLABLE)

TILLABLE SOILS

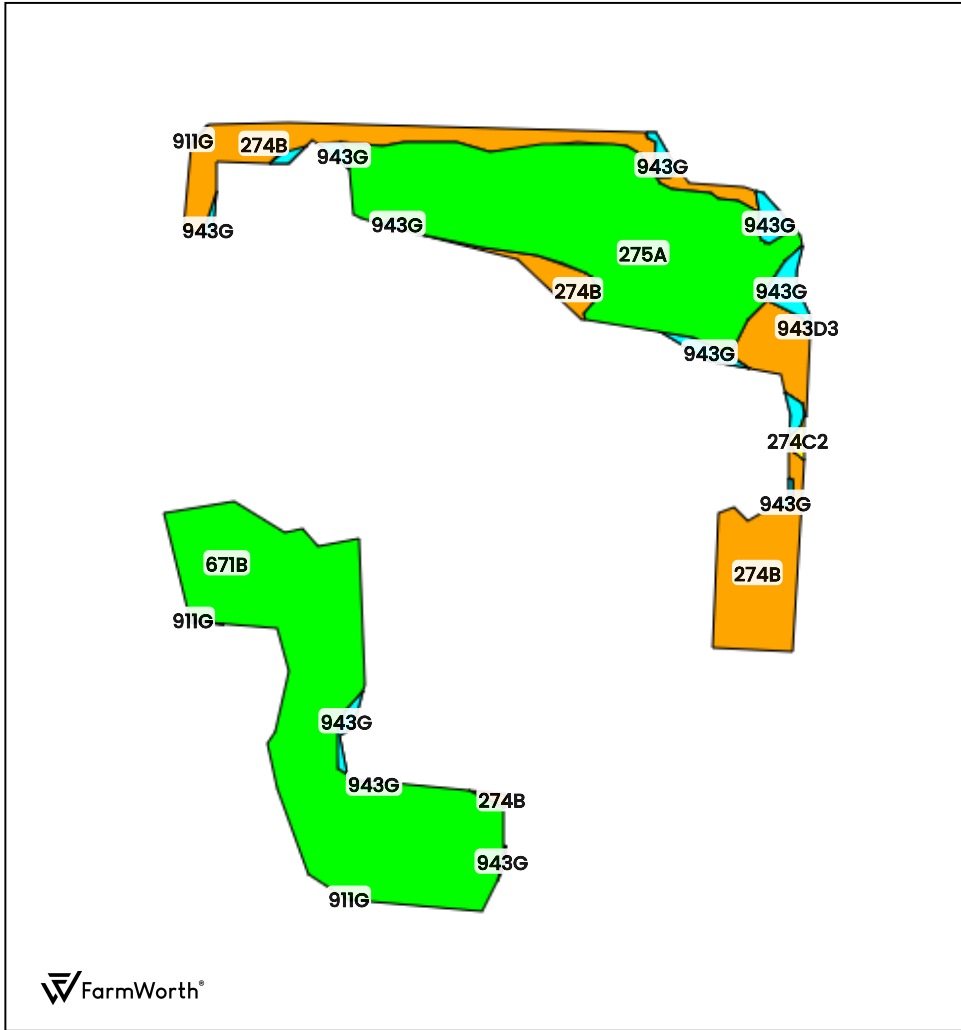

County: **Mercer County, IL**
 Location: **26-14N-5W**
 Township: **New Boston**
 Acres: **85.52**
 Date: **06/09/2026**



FarmWorth, LLC makes no warranties, express or implied, regarding the accuracy of any information provided through FarmWorth.com. User is solely responsible for independently verifying all information prior to use and waives any claims against FarmWorth, LLC arising from inaccuracies in such information.

Code	Description	Acres	% of field	IL PI	Overall NCCPI	Soil Class (Non-Irr)	Drainage Class
671B	Biggsville silt loam, 2 to 5 percent slopes	30.41	35.56 %	140	92	2	Well drained
275A	Joy silt loam, 0 to 2 percent slopes	28.79	33.67 %	144	94	1	Somewhat poorly drained
274B	Seaton silt loam, 2 to 5 percent slopes	18.47	21.59 %	118	94	2	Well drained
943G	Seaton-Timula silt loams, 35 to 60 percent slopes	7.49	8.76 %	55	20	7	Well drained
274C2	Seaton silt loam, 5 to 10 percent slopes, eroded	0.21	0.25 %	111	87	3	Well drained
911G	Timula-Hickory silt loams, 35 to 60 percent slopes	0.13	0.16 %	50	17	7	Well drained
943D3	Seaton-Timula silt loams, 10 to 18 percent slopes, severely eroded	0.02	0.02 %	92	70	6	Well drained
Average:					128.9	86.7	

IL Productivity Index calculations are based on Bulletin 811 and obtained from the [NRCS Field Office Technical Guide](#). Soils data provided by USDA and NRCS.